

10

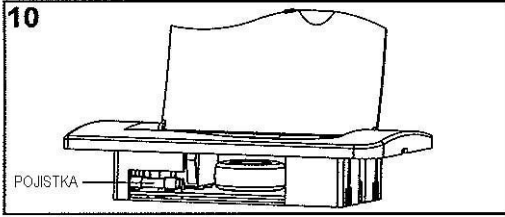

POJISTKA

Práva na změny vyhrazena.

Multi-VAC spol. s r.o. - pobočky  
 Fáblovka 552, 533 52 Staré Hradiště, tel. +420 466 769 201, fax +420 466 769 209, pardubice@multivac.cz  
 Vodičská 1853, 251 01 Říčany u Prahy, tel. +420 323 616 080, fax +420 323 616 089, praha@multivac.cz  
 Videňská 120, 619 00 Brno, tel. +420 547 423 150, fax +420 547 423 159, brno@multivac.cz  
 K Nemocnici 61/2122, 741 01 Nový Jičín, tel. +420 556 455 071, fax +420 556 455 079, njicin@multivac.cz  
 www.multivac.cz

8

# MULTI VAC

## NÁVOD NA REGULÁTORY R10, R15

1

VITRO 6/150M ÷ 6/150M-LC ÷ 9/230M

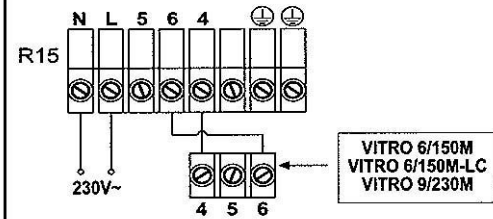

AXC 100 ÷ AXC 200B

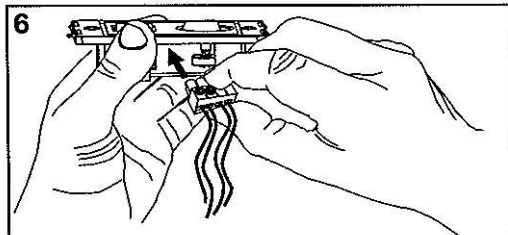
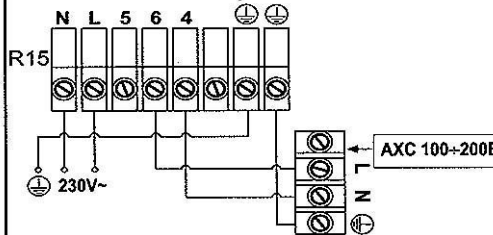

6

### INSTALACE

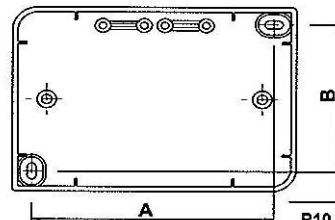

	A (mm)	B (mm)
R10	93.8	63.8
R15	121.8	63.8

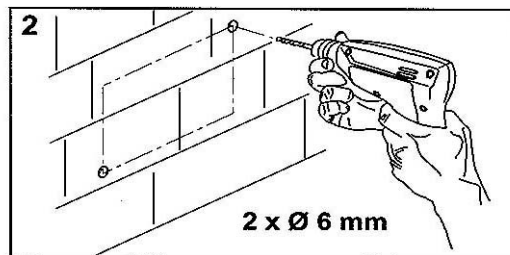
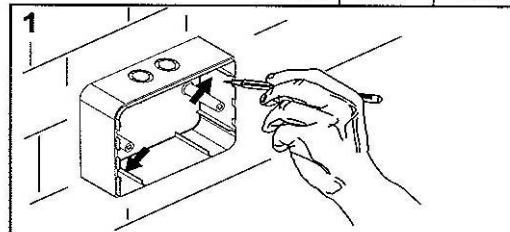

2 x Ø 6 mm

3

Fig.A

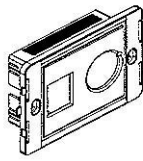

FIREMNÍ ŠTÍTEK

OBSAH BALENÍ

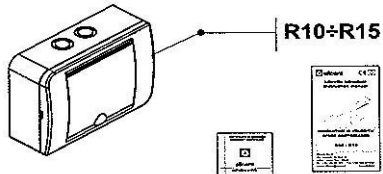

- 4 x (Ø 2,9x13)
- 2
- 2 x (Ø 3,5x32)
- 2
- 2 x (Ø 3,5x19,5)
- 1

2

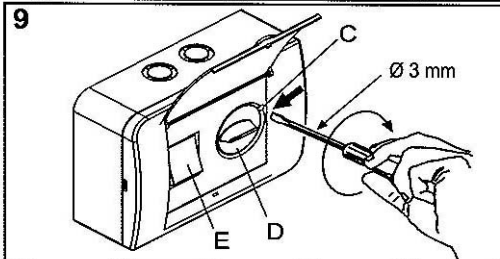
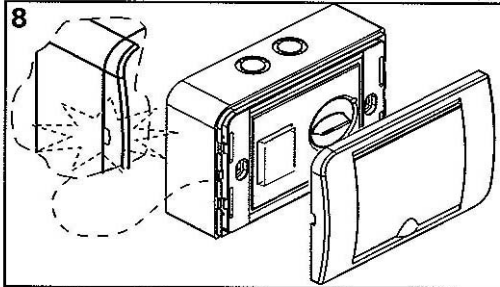
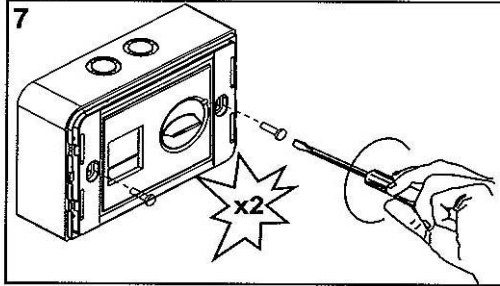

7

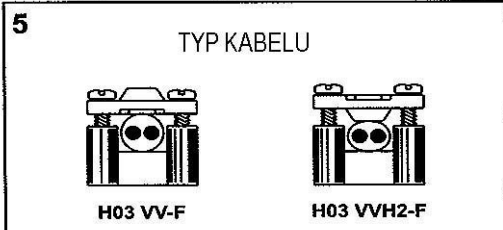
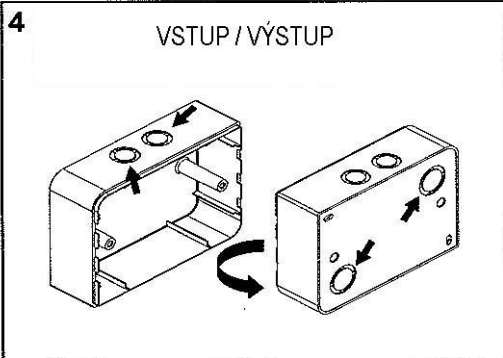
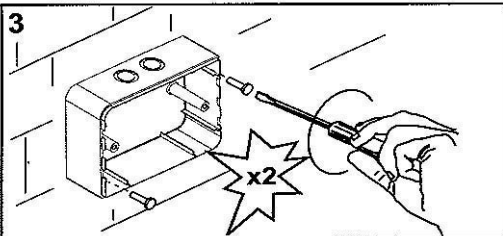

4

SCHÉMA ZAPOJENÍ

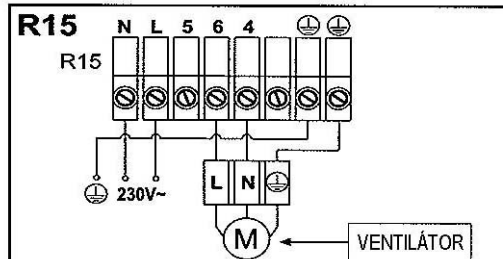
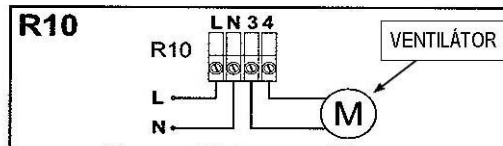

VITRO 6/150A + 6/150A-LC

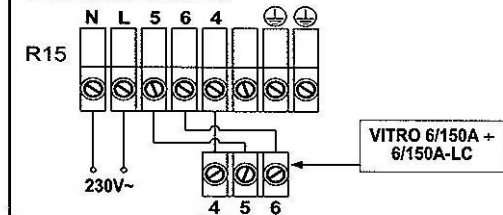

5